



| | | |
|----------------|---|---|
| ITEM | PODGY pendant |   DIMMABLE LED ONLY! |
| MATERIAL | Lamp shade: Steel & aluminium Cord: Coated fabric | |
| LIGHT SOURCE | 3 x E27 bulb LED dimmable max. 8 W (not included) 220-240V AC 50Hz recommended bulbs: Philips 9W (806 lumen) dimmable LED, Warm glow Dura 7,5W (850 lumen) dimmable LED, Tecno vintage Some LED dimmable bulbs can have a slight noise. The above mentioned are silent. | |
| ITEM DIMENSION | Lamp shade: Diameter: 42 cm / Height: 27 cm Cord: 400 cm (no plug) | |
| BOX DIMENSION | Height: 35,5 cm / Width: 50 cm / Length: 50 cm | |
| WEIGHT | 6 kg including packaging and transportation box | |

Made in China
Designed in Denmark

PLEASE WAIT to be SEATED A/S
Frederiksgade 1, 1. floor
DK-1265 Copenhagen K
Denmark

pleasewaittobeseated.com

PLEASE WAIT

Design by KRØYER-SÆTTER-LASSEN

PODGY pendant

USER MANUAL

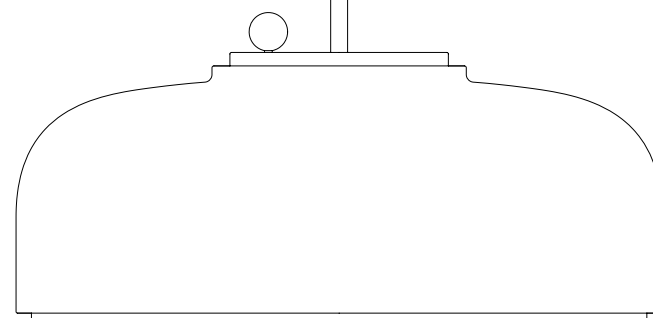

DIMMABLE LED ONLY!

SEATED

to be

Introduction

Congratulations on your purchase and welcome to the world of PLEASE WAIT to be SEATED.

Inspired by a photographer's use of light, PODGY pendant strives to create an accurate light that serves the needs of everyday life. By combining several classic elements from Scandinavian design heritage with a refined expression focusing on composition and materiality Krøyer-Sætter-Lassen has put PODGY pendant into a contemporary present.

Integrated in PODGY pendant is a honeycomb aluminium structure that creates an indirect and pleasant light. Due to its abilities the honeycomb is originally used by photographers to enable a soft, controlled lightning in the photo studio.

Adjusting the density of light on the spherical dimmer on top of PODGY pendant creates, besides from a noticeable graphic element, a playful interaction between the lamp and you.

Design: Krøyer-Sætter-Lassen

Important

Read this user manual carefully before you use the appliance and save it for future reference.

Danger

- Water and electricity are a dangerous combination. Do not use this appliance in wet surroundings (e.g. in the bathroom or near a shower or swimming pool)
- Do not let water run into the appliance or spill water onto the appliance

Warning

- Check if the voltage indicated on the appliance corresponds to the local mains voltage before you connect the appliance
- The appliance is suitable for mains voltages of 220-240 V
- If the mains cord is damaged, you must have it replaced by a professional
- Children should be supervised to ensure that they do not play with the appliance
- This appliance is for indoor use only

Caution

- Do not drop the appliance or expose it to heavy shocks
- Never use the appliance if the lamp housing is damaged, broken or missing
- The appliance's ON/OFF switch is the circular dimmer on top of the lampshade.
- To disconnect the appliance from the mains turn off electricity on the mains electrical supply in fuse or circuit box
- This appliance is only intended for household use, including similar use for instance in hotels
- Do not touch the honeycomb structure as it dents easily. When manoeuvring the honeycomb only touch the rim of the honeycomb.

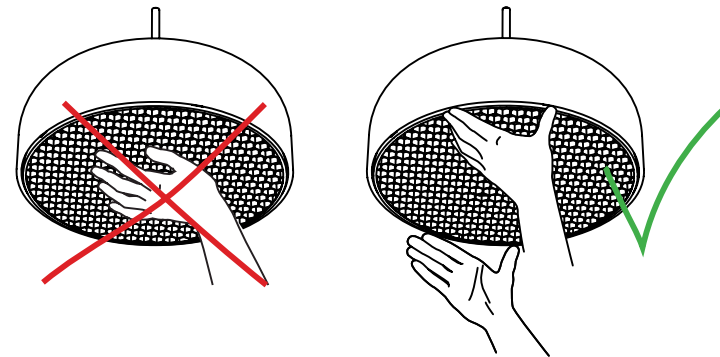

Cleaning

- Turn off electricity.
- Clean with dry or moist cloth. Afterwards use a dry towel to remove all moist.

Light bulbs

We recommend that you use the following models:

- Philips 9W (806 lumen) dimmable LED bulbs
- Dura 7,5W (850 lumen) dimmable LED bulbs, Tecno Vintage.

These can be bought at www.pleasewaittobeseated.com

Some LED dimmable bulbs brands can appear to make a slightly buzzing noise

User instructions

1. Mounting canopy

A. Turn off the mains electrical supply in fuse or circuit box. Carefully remove all parts from carton. Do not discard any parts. Remove screws from canopy and save them for later. Determine the desired drop from ceiling to lamp.

B. Cut the cord in the desired length. Then strip 3" of the outer insulation from cord and 5/16" of insulation from the two conductors that are now exposed.

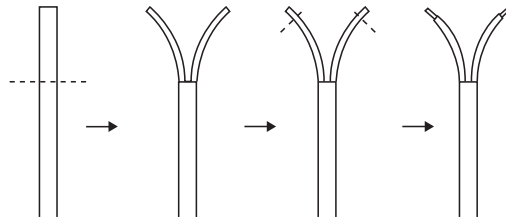

C. Feed the mains supply cable through the insulating tube into the connector box. Ensure the power is switched off.

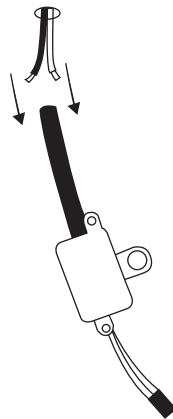

D. Open the connector box and connect the mains supply cables to the corresponding cables from the lamp. Close and secure the connector box, making sure that the insulating tube covers the wire supply from the ceiling.

Please note: it is recommended that a qualified electrician connects the power in this step.

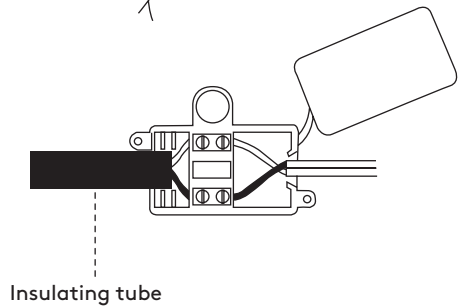
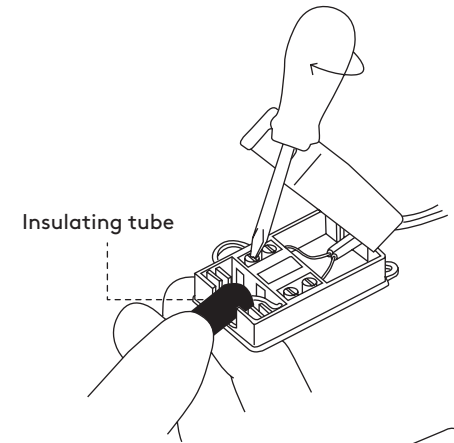

E. Put the insulating tube into the ceiling hole. Connector box can store inside the canopy.

Attach mounting plate with provided screws. Place canopy onto mounting plate and attach the canopy with the screws you started by removing.

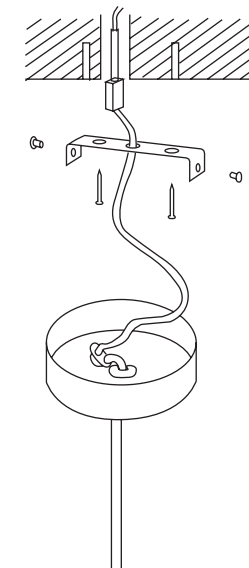

2. Insert bulbs

When PODGY pendant is hanging from the ceiling insert 3 x E27 bulbs (8 W dimmable LED).
Use DIMMABLE LED only!

3. Insert honeycomb

The honeycomb has 3 pins on the rim that serves as supports when the honeycomb is inserted in the shade.

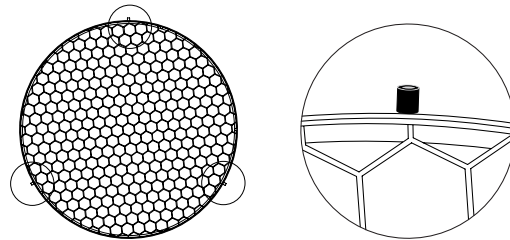

Insert the honeycomb by tipping it while inserting it into the lampshade. The 3 pins on the honeycomb will rest on the inside edge of the lampshade.

OBS! Be careful when maneuvering the honeycomb as the material is delicate and dents easily. When inserting the honeycomb make sure that you hold onto the rim only.

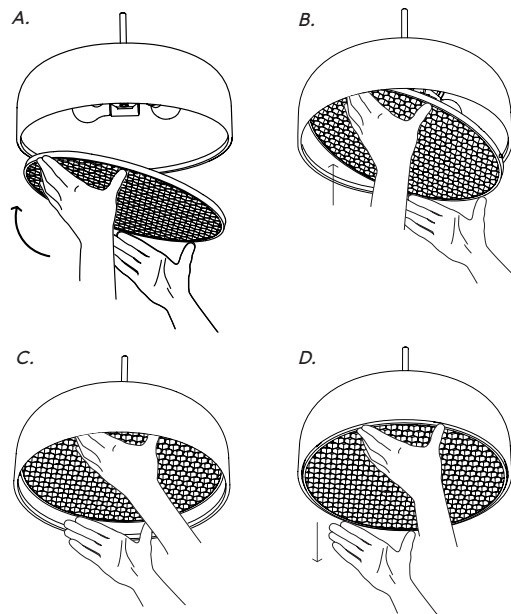

On/off/dim

On top of PODGY pendant is a circular dimmer that enables the light to be dimmed and to be turned on and off. Dim up by turning the dimmer clockwise and dim down by turning the dimmer counter clockwise. Turn off by turning the dimmer counter clockwise until the dimmer "clicks".

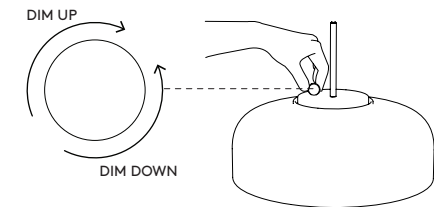

OBS! Do not force the dimmer.

Replacing the bulbs

In order to change the bulbs the honeycomb must be removed. Repeat step 3 only opposite: Tip the honeycomb and remove it carefully without touching the honeycomb structure.

For more information about
PODGY pendant, visit
pleasewaittobeseated.com